

Public notice

St. Mark's Square area - bus priority measures

*The Camden (Parking Places, Loading Places and Waiting, Loading and Stopping Restrictions) (Amendment No. *) Order 202**

1. NOTICE IS HEREBY GIVEN that the Council of the London Borough of Camden ('the Council') propose to make the above Order under sections 6, 45, 46, 49 and 124 of and Part IV of Schedule 9 to the Road Traffic Regulation Act 1984, as amended.
2. The general nature and effect of the Order would be:
 - (a) in ST. MARK'S SQUARE (west to east arm) and REGENT'S PARK ROAD:
 - (i) to provide 'at any time' loading restrictions, on the south side, between the western kerb-line of St. Mark's Square (north to south arm) and a point 10 metres west of that kerb-line;
 - (ii) to convert 'controlled hours' waiting restrictions to 'at any time' waiting and loading restrictions:
 - (A) on the north side, between a point 1.5 metres east of the common boundary of Nos. 9 and 10 St. Mark's Square and a point 36 metres east of that common boundary;
 - (B) on the south side:
 - (I) between a point 36.5 metres east of the eastern kerb-line of St. Mark's Square (north to south arm) and a point 18 metres west of the common boundary of Nos. 27 and 29 Regent's Park Road;
 - (II) between a point 1 metre east of the common boundary of Nos. 27 and 29 Regent's Park Road and a point 7.6 metres east of that common boundary; and
 - (iii) to convert 'controlled hours' waiting restrictions to 'at any time' waiting restrictions, on the south side, between a point 23 metres east of the eastern kerb-line of St. Mark's Square (north to south arm) and a point 36.5 metres east of that kerb-line; and
 - (b) in ST. MARK'S SQUARE (north to south arm):
 - (i) to provide 'at any time' loading restrictions:
 - (A) on the west side, between the southern kerb-line of Regent's Park Road and a point 9.2 metres south of that kerb-line; and
 - (B) on the east side, between the southern kerb-line of Regent's Park Road and a point 10.3 metres south of that kerb-line; and
 - (ii) to convert 'controlled hours' waiting restrictions to 'at any time' waiting and loading restrictions, on the east side, between a point 10.3 metres south of the southern kerb-line of Regent's Park Road and a point 16.3 metres south of that kerb-line.

3. ADDITIONAL NOTICE IS HEREBY GIVEN, as a courtesy measure, that the Council, under the powers of the Traffic Signs Regulations and General Directions 2016, have approved changes to the bus stop clearway markings on the south side of REGENT'S PARK ROAD. The existing bus stop clearway outside Nos. 29 and 31 Regent's Park Road will be extended, so as to extend from a point 1 metre east of the common boundary of Nos. 27 and 29 Regent's Park Road westward for 19 metres. Vehicles other than local buses will remain prohibited from stopping on the bus stop clearway markings at any time.
4. Copies of the proposed Order, plans indicating the proposals, and other related documents may be obtained by contacting traffic.orders@camden.gov.uk or inspected either: online at camden.gov.uk/recently-advertised-proposals , or by prior appointment in person at 5 Pancras Square, London N1C 4AG - during normal office hours. Any person wishing to object or make representations in respect of the proposals should send comments in writing, quoting reference 'TMO2526-0038' and giving reasons for any objection, to the e-mail address above or by post to 'FREEPOST LBC TRANSPORT STRATEGY', to be received by the end of 19 June 2026.

Peter Mardell – Head of Parking Operations

28 May 2026

Statement of reasons

St. Mark's Square area - bus priority measures

*The Camden (Parking Places, Loading Places and Waiting, Loading and Stopping Restrictions) (Amendment No. *) Order 202**

Project background

- The St Mark's Square Area Bus Priority scheme consists of measures to improve bus journey times and reliability, bus stop accessibility on St Mark's Square/Regent's Park Road, and to support pedestrians on Regent's Park Road.
- This Statement of Reasons sets out the reasons for a number of proposed new measures and associated reasons for these changes.

Summary of changes and reasoning

- Transport for London has identified St Mark's Square/Regent's Park Road as a key area needing bus journey times and reliability improvements. In response to feedback and the full public consultation held during December 2023 and January 2024, the following changes are proposed. Further details of the reasons for the proposals are outlined in section 2 of the main decision report.
- Proposed improvements on St Mark's Square and Regent's Park Road:
 - Widen the footway adjacent to Bus Stop A (westbound) outside 29-33 Regent's Park Road. This would provide more space for pedestrians and visitors to the Church and Zoo to walk.
 - Introduce double yellow lines with double kerb markings (no parking/waiting at any time) next to Bus Stop K (eastbound) outside 8 Regent's Park Road, Bus Stop A (westbound) outside 29 Regent's Park Road, on the bridge and on St Mark's Square so that buses are not delayed by parked vehicles
 - Introducing 13.5 metres of double yellow lines with no kerb markings outside the north side of St Mark's Church on St Mark's Square/Regent's Park Road, to allow the local community loading and unloading access at all times.

LONDON BOROUGH OF CAMDEN
TRAFFIC MANAGEMENT ORDER

202* No. ***

The Camden (Parking Places, Loading Places and Waiting, Loading and Stopping Restrictions) (Amendment No. *) Order 202*

Made on ** **** 202*

Coming into force on ** **** 202*

The Council of the London Borough of Camden, after consulting the Commissioner of Police of the Metropolis, in exercise of the powers conferred by sections 6, 45, 46, 49 and 124 of and Part IV of Schedule 9 to the Road Traffic Regulation Act 1984¹, and of all other powers thereunto enabling, hereby make the following Order:

Citation and commencement

1. This Order may be cited as the Camden (Parking Places, Loading Places and Waiting, Loading and Stopping Restrictions) (Amendment No. *) Order 202* and shall come into force on ** **** 202* .

Interpretation

2. (1) In this Order:

“Council” means the Council of the London Borough of Camden;

“map based schedule” means a map tile attached to this Order, to be read in conjunction with this Order and the Order of 2025, which depicts the parking places or loading places designated by this Order, and the waiting or loading or stopping restrictions imposed by this Order, and, in conjunction with the map schedule legend, identifies the type of each particular parking place or loading place or length of waiting or loading or stopping restrictions, and, if appropriate, certain of their governing provisions:

Provided that the Council does not accept responsibility for any inaccuracies contained in the Ordnance Survey data relied upon to create the map based schedule and where a parking place, loading place or waiting or loading or stopping restriction is depicted on the map based schedule, that parking place, loading place or waiting or loading or stopping restriction will continue to apply irrespective of any subsequent changes that have been made to the underlying Ordnance Survey data.

¹ 1984 c.27

“map schedule legend” means the map schedule legend attached to the Order of 2025 which, when used in conjunction with a map tile, identifies the specific type of parking places or loading places designated by this Order, and the waiting or loading or stopping restrictions imposed by this Order, to which the provisions of this Order apply, and, where appropriate, certain of their governing provisions;

“map tile” means an individual map with a specific tile reference, being part of the map based schedule attached to this Order;

“the Order of 2025” means the Camden (Parking Places, Loading Places and Waiting, Loading and Stopping Restrictions) Consolidation Order 2025².

- (2) Any reference in this Order to any other Order or enactment shall be construed as a reference to that Order or enactment as amended, applied, consolidated, re-enacted by, or as having effect by virtue of any subsequent Order or enactment.
- (3) Unless the context otherwise requires, any expression used in this Order which is also used in the Order of 2025 shall have the same meaning as in that Order.

Substitution of map tiles

3. (1) Without prejudice to the validity of anything done or to any liability incurred in respect of any act or omission before the coming into force of this Order, the Order of 2025 shall have effect as though for the map tiles attached to that Order there were substituted the map tiles similarly referenced and attached to this Order.
- (2) The substitution of any map tile referred to in paragraph (1) of this Article will have the effect of revoking or omitting any provision designated or imposed or applied by a previous version of that map tile and not incorporated into the latest version.

Designation of parking places or loading places and application of the Order of 2025 thereto

4. (1) Each area on a street identified in a map tile as a parking place or loading place and, where applicable, by way of the map schedule legend as an area marked out or signed for the use therein of specified classes of vehicles following the conditions specified in the Order of 2025 in relation to that type of parking place or loading place, as the case may be, is designated as a parking place or a loading place.
- (2) Unless otherwise so identified, a parking place or loading place shall be bounded on one side of its length by the edge of the carriageway and be an area marked either by a traffic sign or by another method of indicating the extent of a parking place as specified in the Traffic Signs Regulations and General Directions 2016³.

² LBC 2025/023

³ SI 2016/362

- (3) The provisions of the Order of 2025 shall apply to an area designated as a parking place or loading place by this Order as if in those provisions any reference to a parking place or loading place, as the case may be, included a reference to an area designated as a parking place or loading place by this Order.

Waiting restrictions, loading restrictions and stopping restrictions and application of the Order of 2025 thereto

5. Without prejudice to the validity of anything done or to any liability incurred in respect of any act or omission before the coming into force of this Order, the Order of 2025 shall have effect as though:-
 - (a) any waiting restriction or loading restriction identified in a map tile and, where applicable, by way of either a map tile label or the map schedule legend, or both, and marked out or signed as a waiting restriction or a loading restriction shall be construed as through it were a restricted street referred to in the Order of 2025; and
 - (b) any stopping restriction identified in a map tile and, where applicable, by way of either a map tile label or the map schedule legend, or both, and marked out or signed as a stopping restriction shall be construed as through it were a stopping restriction referred to in the Order of 2025.

Placing of traffic signs, etc.

6. The Council shall:
 - (a) place and maintain traffic signs or other appropriate markings on the surface of the street indicating the limits of each parking place or loading designated by, or each length of waiting or loading or stopping restrictions imposed by, this Order; and
 - (b) carry out such other work as is reasonably required for the purpose of the satisfactory operation of such parking place, loading place, or length of waiting or loading or stopping restrictions.

Dated this ** ** 202***

Peter Mardell

Head of Parking Operations

EXPLANATORY NOTE

(This Note is not part of the Order)

This Order amends the Camden (Parking Places, Loading Places and Waiting, Loading and Stopping Restrictions) Consolidation Order 2025 so as:

- (a) in St. Mark's Square (west to east arm) and Regent's Park Road:
 - (i) to provide 'at any time' loading restrictions, on the south side, between the western kerb-line of St. Mark's Square (north to south arm) and a point 10 metres west of that kerb-line;
 - (ii) to convert 'controlled hours' waiting restrictions to 'at any time' waiting and loading restrictions:
 - (A) on the north side, between a point 1.5 metres east of the common boundary of Nos. 9 and 10 St. Mark's Square and a point 36 metres east of that common boundary; and
 - (B) on the south side:
 - (I) between a point 36.5 metres east of the eastern kerb-line of St. Mark's Square (north to south arm) and a point 18 metres west of the common boundary of Nos. 27 and 29 Regent's Park Road;
 - (II) between a point 1 metre east of the common boundary of Nos. 27 and 29 Regent's Park Road and a point 7.6 metres east of that common boundary; and
 - (iii) to convert 'controlled hours' waiting restrictions to 'at any time' waiting restrictions, on the south side, between a point 23 metres east of the eastern kerb-line of St. Mark's Square (north to south arm) and a point 36.5 metres east of that kerb-line; and
- (b) in St. Mark's Square (north to south arm):
 - (i) to provide 'at any time' loading restrictions:
 - (A) on the west side, between the southern kerb-line of Regent's Park Road and a point 9.2 metres south of that kerb-line; and
 - (B) on the east side, between the southern kerb-line of Regent's Park Road and a point 10.3 metres south of that kerb-line; and
 - (ii) to convert 'controlled hours' waiting restrictions to 'at any time' waiting and loading restrictions, on the east side, between a point 10.3 metres south of the southern kerb-line of Regent's Park Road and a point 16.3 metres south of that kerb-line.

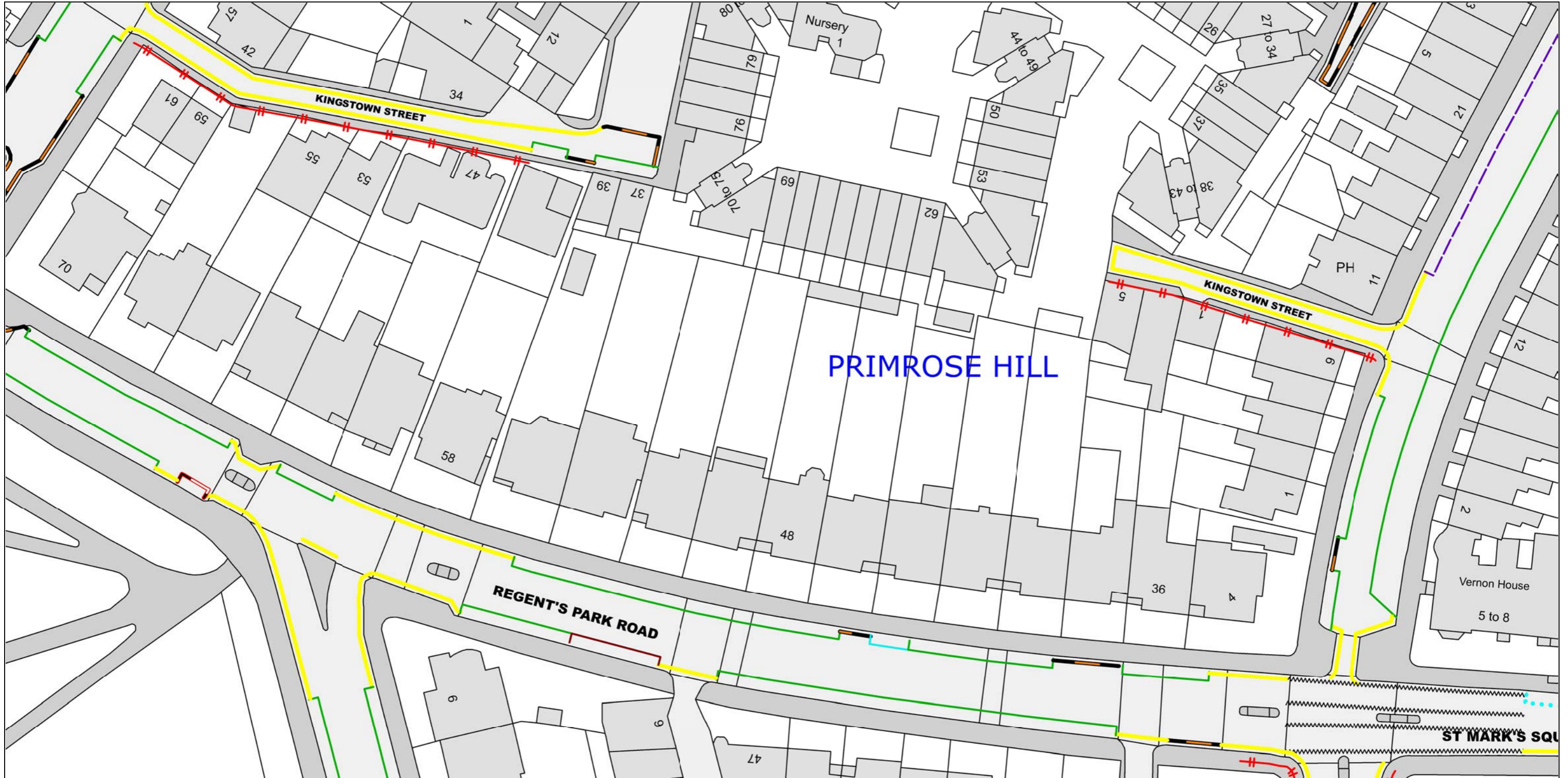

NOTE: SEE STATIC MAP SCHEDULE LEGEND FOR RESTRICTIONS DISPLAYED

SCALE - 1 : 625 at A3 size

This map is reproduced from Ordnance Survey material with the permission of Ordnance Survey on behalf of the Controller of Her Majesty's Stationery Office © Crown Copyright. Unauthorised reproduction infringes Crown copyright and may lead to prosecution or civil proceedings.
 LB Camden
 Licence No: 100019726 2026



Key to Restriction Types Displayed

- No stopping except local buses
- Disabled Blue Badge Holders Only
- Dockless Cycle Hire
- Electric Vehicle Charging Only
- + + No Loading At Any Time
- ~ ~ ~ ~ Pedestrian Crossing
- Permit Holders Only CA-J Mon-Fri 8.30am-6pm
- No Waiting At Any Time
- No Waiting Mon-Fri 8.30am-6pm
- Paid Parking Only Mon-Fri 8.30am-6pm Max Stay 2hrs No Return Within 1hr Permit Holders Only CA-J Mon-Fri 8.30am-6pm

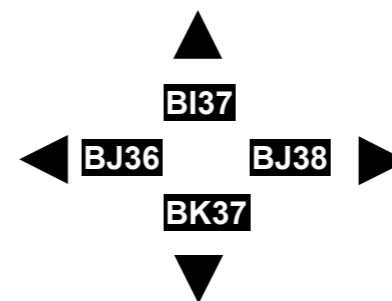

Status: PROPOSE

Map Tile Reference: Tile Ref: BJ37

Sheet Revision Number:

Sheet Active From: 09/02/2026

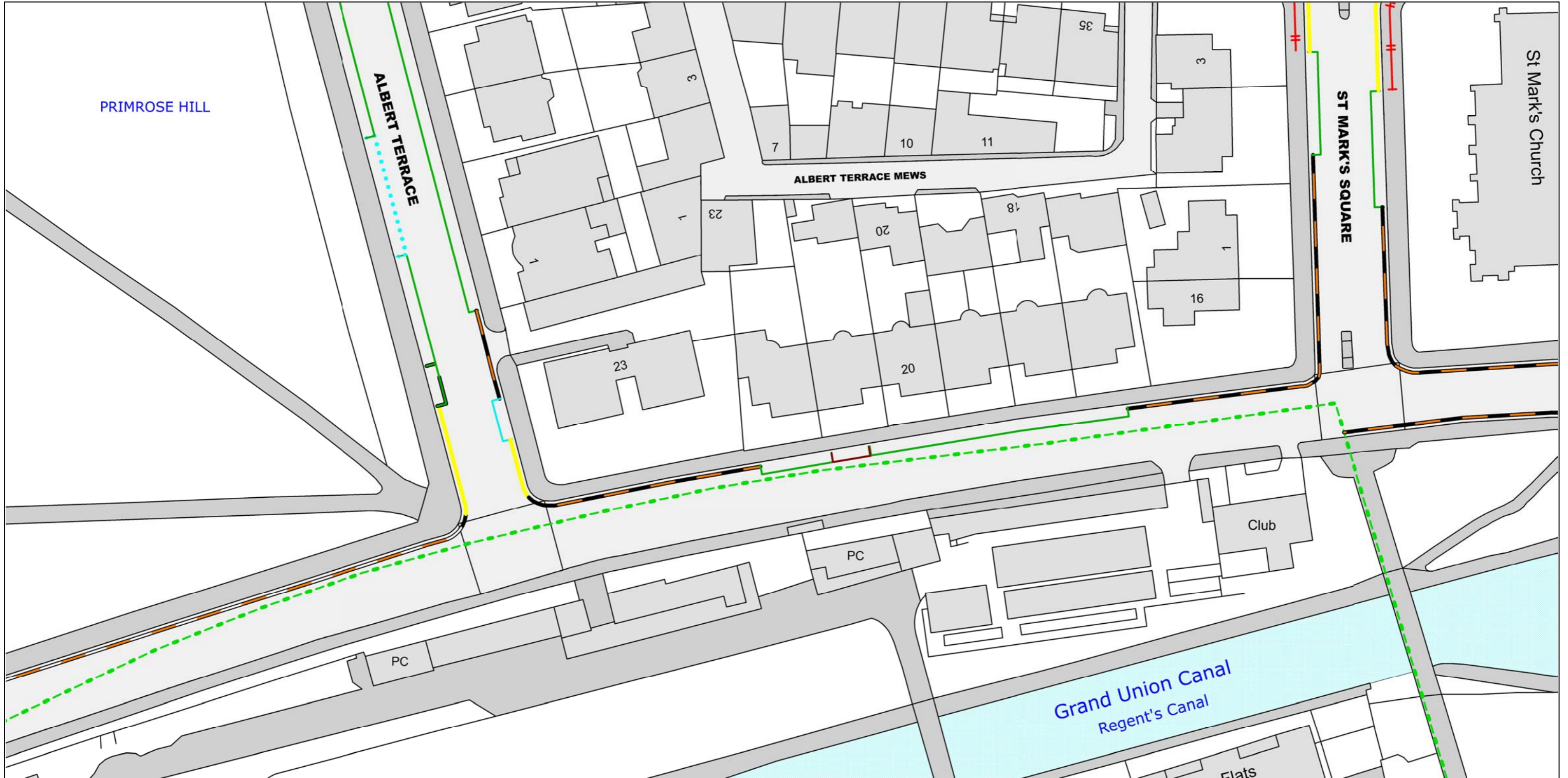

PRIMROSE HILL

ALBERT TERRACE

ALBERT TERRACE MEWS

ST MARK'S SQUARE

St Mark's Church

Club

PC

PC

Grand Union Canal
Regent's Canal

Flats

SCALE - 1 : 625 at A3 size

NOTE: SEE STATIC MAP SCHEDULE LEGEND FOR RESTRICTIONS DISPLAYED

This map is reproduced from Ordnance Survey material with the permission of Ordnance Survey on behalf of the Controller of Her Majesty's Stationery Office © Crown Copyright. Unauthorised reproduction infringes Crown copyright and may lead to prosecution or civil proceedings.
LB Camden
Licence No: 100019726 2026



Key to Restriction Types Displayed

- No stopping except local buses
- Disabled Blue Badge Holders Only
- Electric Vehicle Charging Permit Holders Only CA-J Max stay 12hrs No Return Within 2hrs
- ⊢ No Loading At Any Time
- Permit Holders Only ICE
- - - - - Permit Holders Only CA-J Mon-Fri 8.30am-6pm
- No Waiting At Any Time
- No Waiting Mon-Fri 8.30am-6.30pm
- No Waiting Mon-Fri 8.30am-6pm

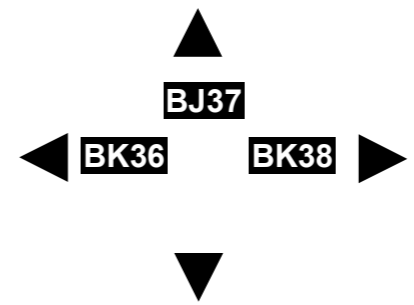

Status: PROPOSE

Map Tile Reference: Tile Ref: BK37

Sheet Revision Number:

Sheet Active From: 09/02/2026



NOTE: SEE STATIC MAP SCHEDULE LEGEND FOR RESTRICTIONS DISPLAYED

SCALE - 1 : 625 at A3 size

This map is reproduced from Ordnance Survey material with the permission of Ordnance Survey on behalf of the Controller of Her Majesty's Stationery Office © Crown Copyright. Unauthorised reproduction infringes Crown copyright and may lead to prosecution or civil proceedings.
 LB Camden
 Licence No: 100019726 2026



Key to Restriction Types Displayed

- No stopping except local buses
- Islands & build-outs not shown in OS
- No Loading At Any Time
- Pedestrian Crossing
- Permit Holders Only CA-J Mon-Fri 8.30am-6pm
- No Waiting At Any Time
- No Waiting Mon-Fri 8.30am-6pm

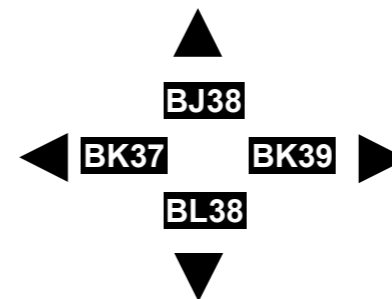

Status: PROPOSE

Map Tile Reference: Tile Ref: BK38

Sheet Revision Number:

Sheet Active From: 09/02/2026

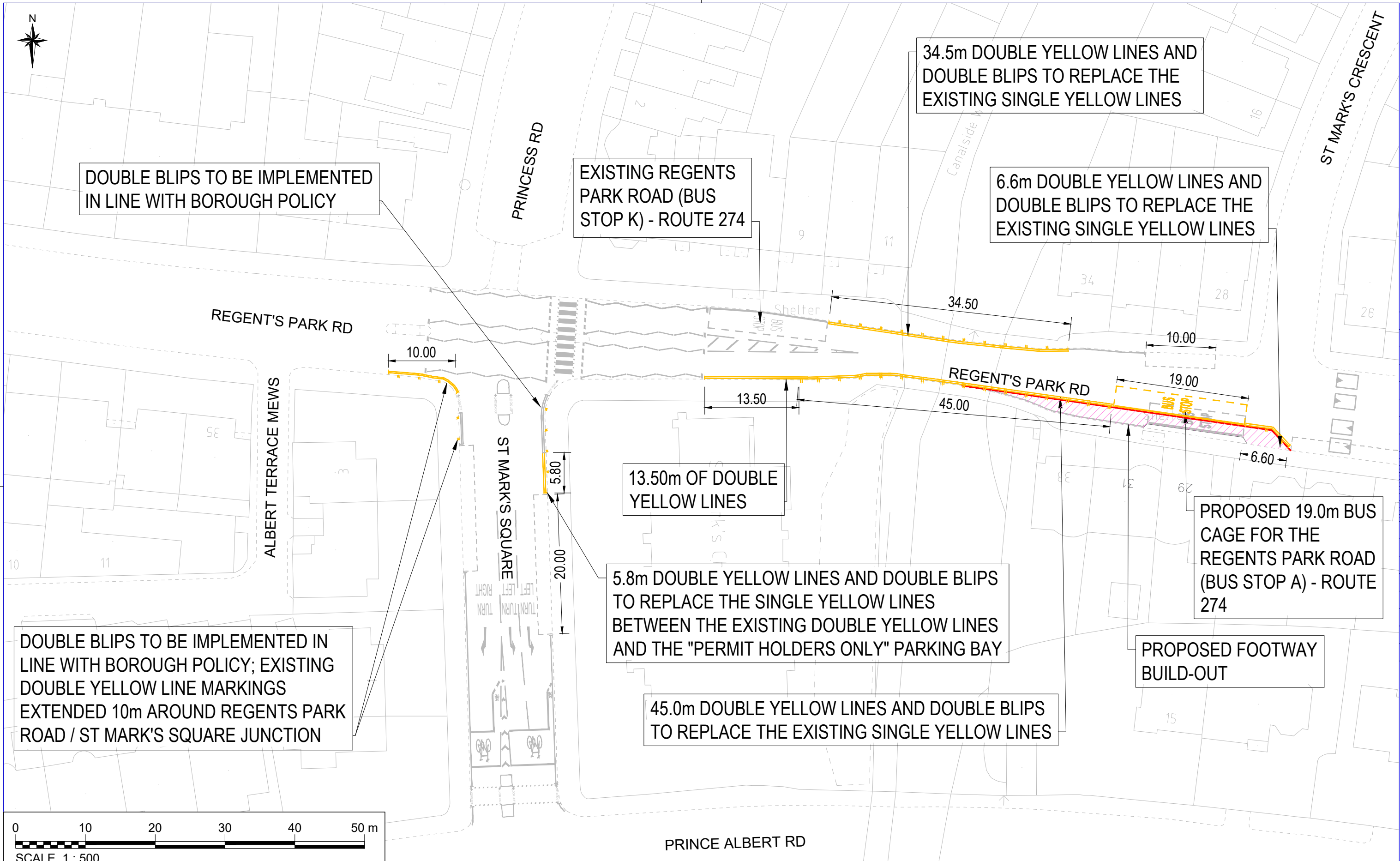

DOUBLE BLIPS TO BE IMPLEMENTED IN LINE WITH BOROUGH POLICY

EXISTING REGENTS PARK ROAD (BUS STOP K) - ROUTE 274

34.5m DOUBLE YELLOW LINES AND DOUBLE BLIPS TO REPLACE THE EXISTING SINGLE YELLOW LINES

6.6m DOUBLE YELLOW LINES AND DOUBLE BLIPS TO REPLACE THE EXISTING SINGLE YELLOW LINES

REGENT'S PARK RD

ALBERT TERRACE MEWS

ST MARK'S SQUARE

13.50m OF DOUBLE YELLOW LINES

5.8m DOUBLE YELLOW LINES AND DOUBLE BLIPS TO REPLACE THE SINGLE YELLOW LINES BETWEEN THE EXISTING DOUBLE YELLOW LINES AND THE "PERMIT HOLDERS ONLY" PARKING BAY

PROPOSED 19.0m BUS CAGE FOR THE REGENTS PARK ROAD (BUS STOP A) - ROUTE 274

PROPOSED FOOTWAY BUILD-OUT

45.0m DOUBLE YELLOW LINES AND DOUBLE BLIPS TO REPLACE THE EXISTING SINGLE YELLOW LINES

DOUBLE BLIPS TO BE IMPLEMENTED IN LINE WITH BOROUGH POLICY; EXISTING DOUBLE YELLOW LINE MARKINGS EXTENDED 10m AROUND REGENTS PARK ROAD / ST MARK'S SQUARE JUNCTION



SCALE 1 : 500

Camden
Design Team
Transport Strategy Service
London Borough of Camden
5 Pancras Square
Tel 020 7974 5551, Fax 020 7974 6952
DX 2106 Euston, Minicom 020 7974 6866

NOTES

Project
TfL Bus Priority Programme
London Borough of Camden
St Mark's Square

Drawing Title
Traffic Management Order

KEY

- Existing Road Markings
- Proposed Road Markings
- Proposed Waiting Restrictions
- Proposed Kerbline

Rev	By	Date	Amendments

Scale 1 : 500 @ A3	Date NOV 2025
Drawn By UG	File Ref
Checked By RC	Dwg Name
Drawing Location	
Drawing Number TfLBPP-St Mark's Square-001	Rev. A